

**RF Based Anti-Collision System
for Overhead Crane Applications**

RAC

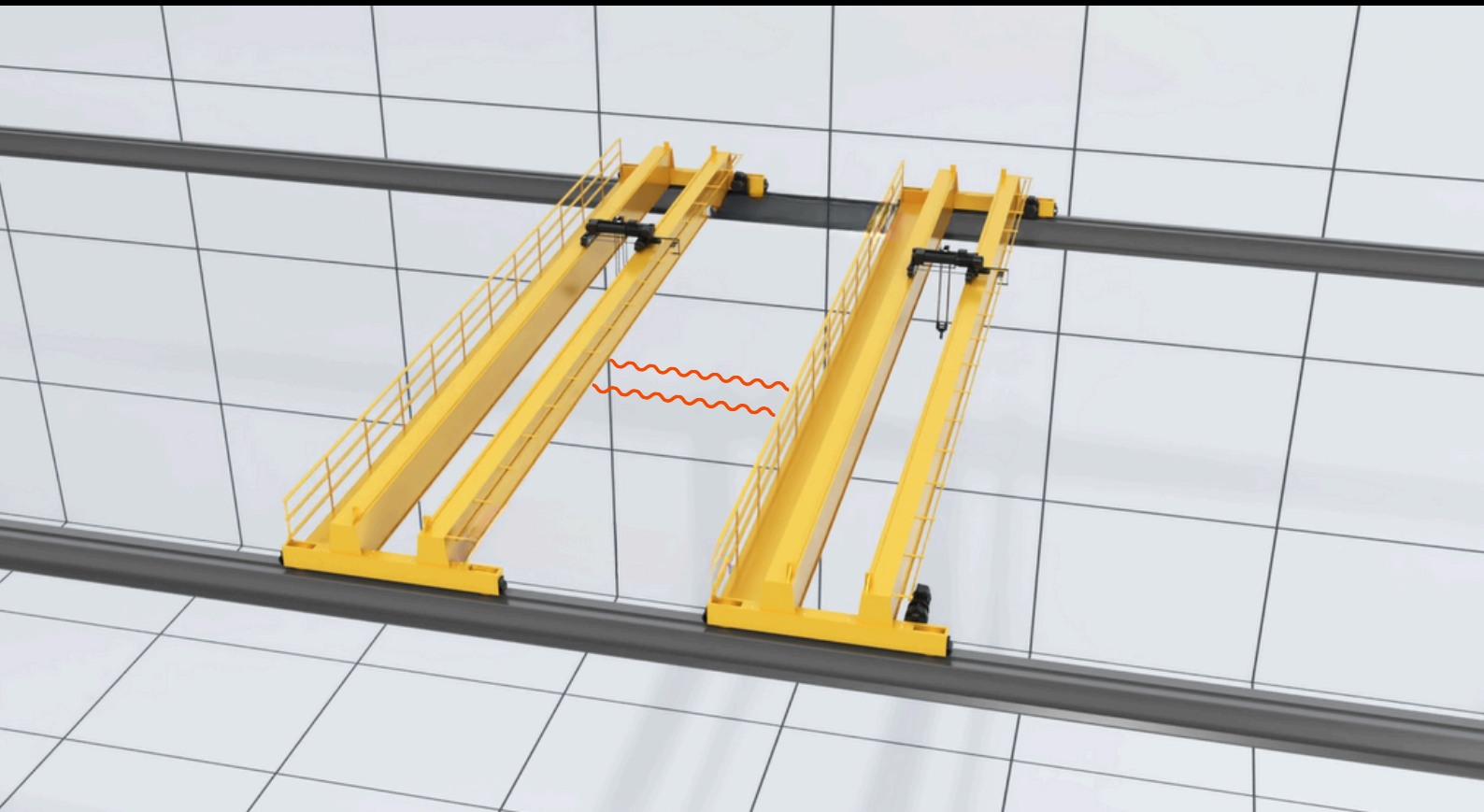

**Ideal for use where optic/light based systems
do not work - smoky, hazy, steamy
environments and outdoor applications**

RF Smart Collision Avoidance Systems

RAC

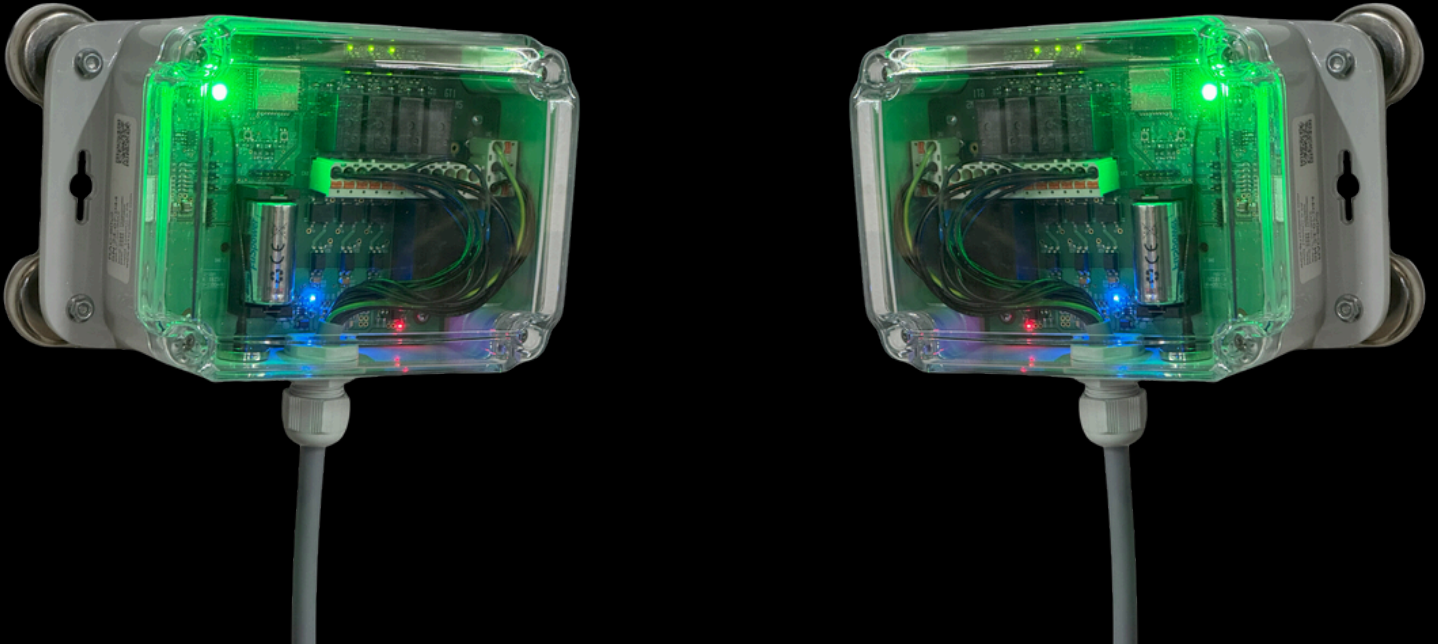

- 60 meter range
- Transmitter/receiver configuration - precise alignment is not necessary, but line of sight between the two units is needed
- Not impacted by the environment
- Setup via WiFi webapp
- Full speed reverse feature allows for immediate full speed when separating cranes
- 4 NO/NC 240/120V 5A relay outputs for warning, slow, stop + error
- Battery backup in case of loss of power on one crane
- 6Ghz frequency band
- NEMA 4X IP68 rated enclosure
- 120V input for bypass or programmable bypass via webapp
- Optional magnet mounts
- 20 foot hardwired pigtail
- Can be used on 230VDC cranes when supplied with GT1 intermediate relay panel

ENGINEERED ———
COMPONENTS
————— **GROUP**

RF Smart Collision Avoidance Systems

RAC

Wiring Information

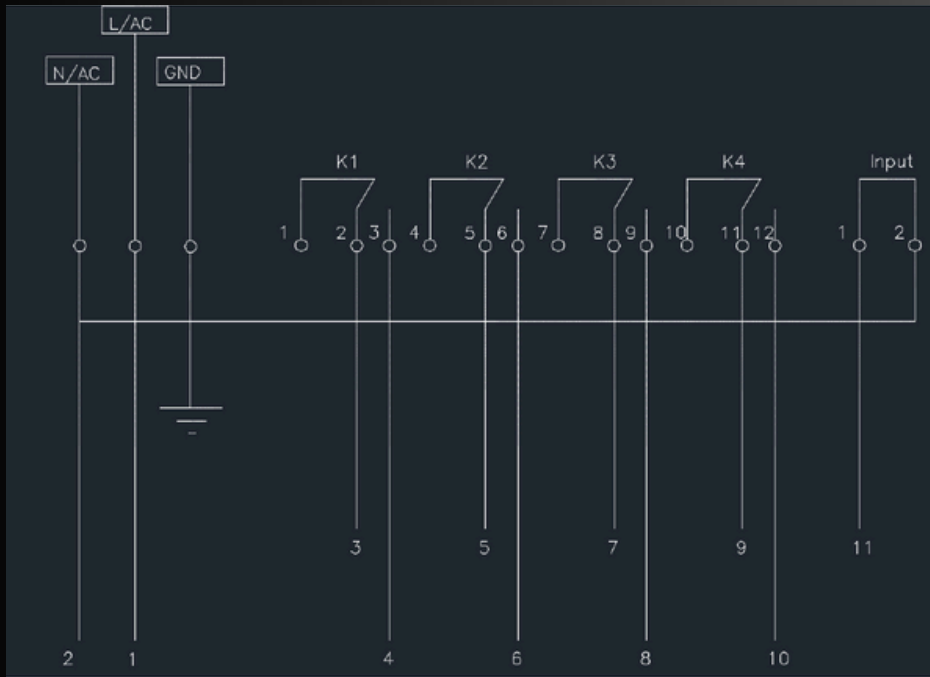

Optional Magnet Mounts

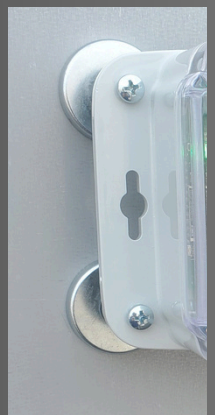

Mounting Hole & Enclosure Dimensions

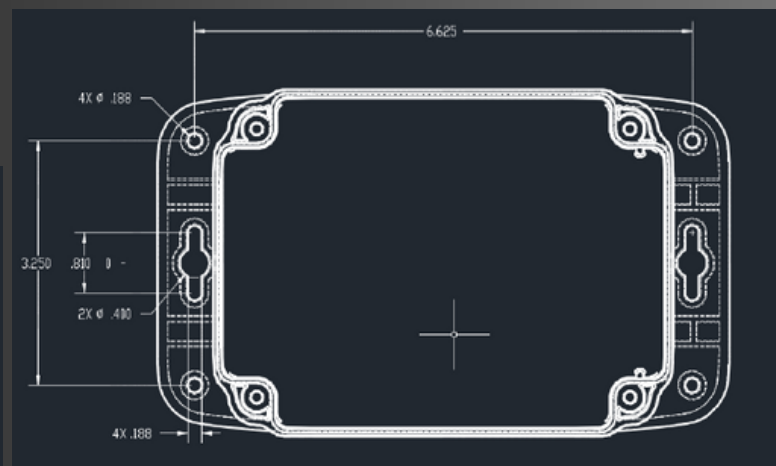
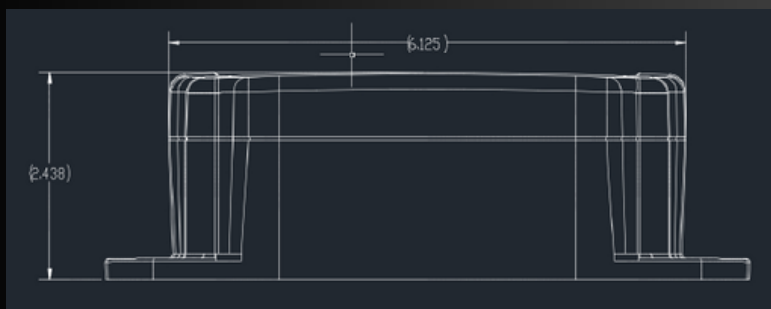

ENGINEERED
COMPONENTS
GROUP

RF Smart Collision Avoidance Systems

RAC

Web App Interface Examples

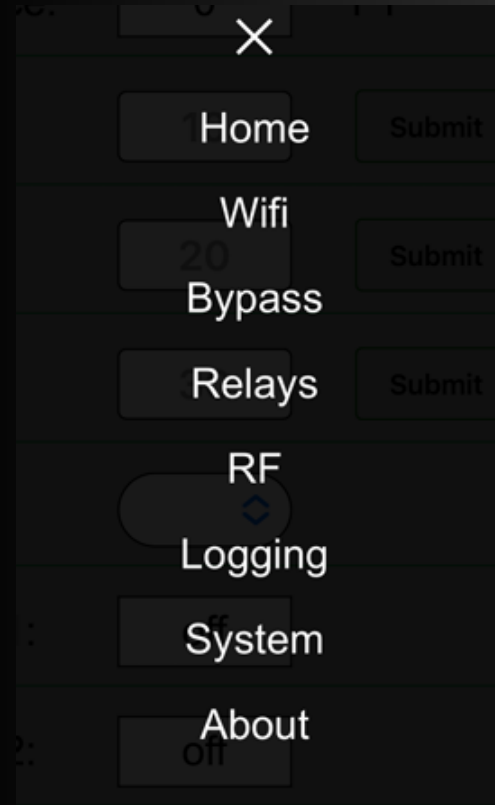

A dark-themed sidebar menu with a close button (X) at the top. The menu items are: Home, Wifi, Bypass, Relays, RF, Logging, System, and About. Each item has a corresponding 'Submit' button to its right.

Main Menu

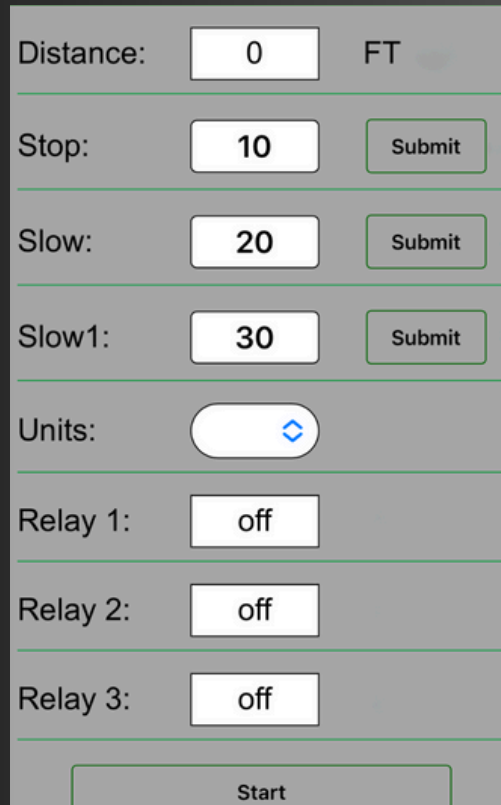

A configuration screen for distance measurement. It includes input fields for 'Distance' (0), 'Stop' (10), 'Slow' (20), and 'Slow1' (30), each with a 'Submit' button. There is a 'Units' toggle set to 'FT' and three 'Relay' status indicators (Relay 1, 2, 3) all set to 'off'. A 'Start' button is at the bottom.

Set Points and Real Time Distance Measurement

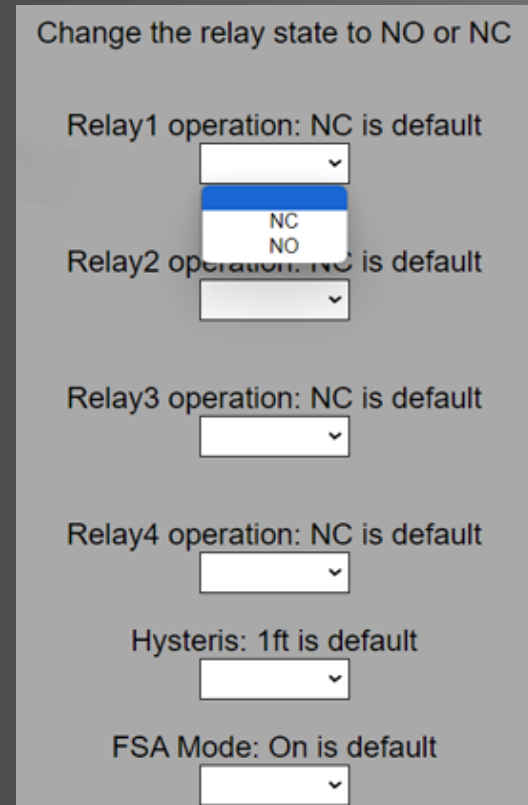

A configuration screen for relay settings. It includes dropdown menus for 'Relay1 operation', 'Relay2 operation', 'Relay3 operation', and 'Relay4 operation', all with 'NC is default' selected. There is also a 'Hysteris' dropdown set to '1ft is default' and an 'FSA Mode' dropdown set to 'On is default'.

Relay Configuration



A form for setting the new SSID name of the device. It includes input fields for 'New SSID', 'SSID', and 'Password', each with a 'Submit' button.

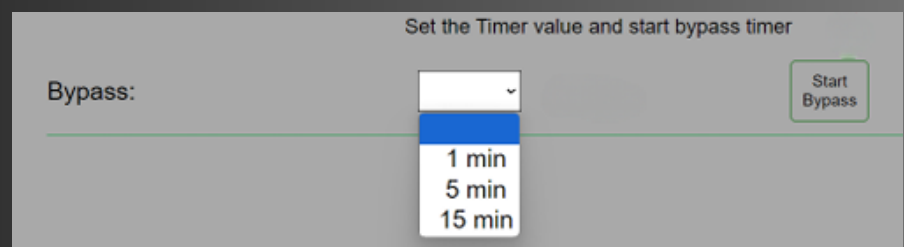

A configuration screen for the bypass timer. It includes a 'Bypass' dropdown menu with options '1 min', '5 min', and '15 min'. A 'Start Bypass' button is at the bottom right.

Secure Bypass Selection -
1 min, 5 min, 15 min, 4 hours, 8 hours

Customer to Name Crane Asset
and Password Protect Access

ENGINEERED
COMPONENTS
GROUP